

Environmental river work for the Amspin sluice on the Meuse: Fish Pass with spawning areas and river bank restoration (Be)

SAR Consult was providing environmental expertise linked to the new sluice structure for 4500 tons barges developed by the experts from Greisch and Tractebel Engineering (with IMDC).

We propose innovative solutions to build a natural fish pass with spawning areas and fish shelters for nase and barbel ($5\text{m}^3/\text{s}$ – 600 meters long). Our role also enticed designing new river bank to improve the biodiversity and the functions of the aquatic ecosystem. The construction works should begin end of 2016/2017.

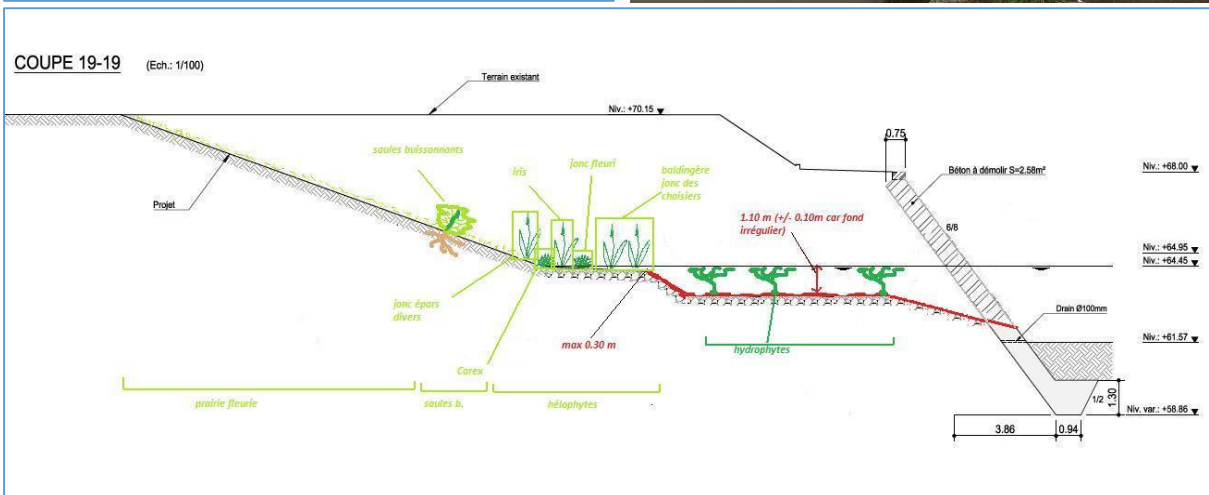
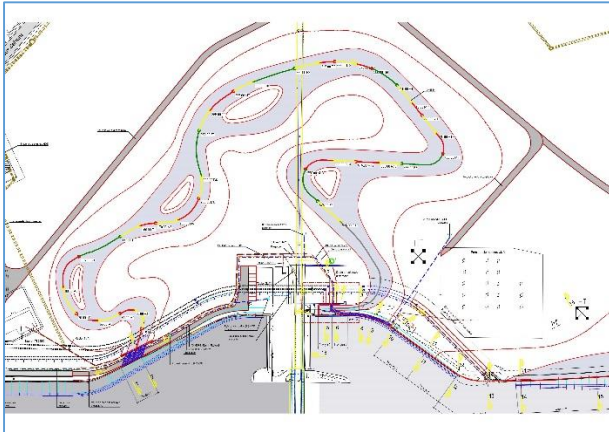

TRACTEBEL Engineering
GDF SUEZ

STREAM
& RIVER CONSULT

IMDC
International Marine & Dredging Consultants

greisch